

# MobilHotspot 4G

## Quick Start Guide

Start here!





**This manual will show you all the ins and outs of your MobiiHotspot 4G, including how it can become a hotspot for your mobile devices at home or when you're out and about.**

## **Getting to know your MobiiHotspot 4G**

### **Connection**

Up to ten Wi-Fi devices can be connected to the Internet through your MobiiHotspot 4G, but we recommend a maximum of 5 to maintain connection quality.

Connecting each device will depend on its operating system.



## Screen

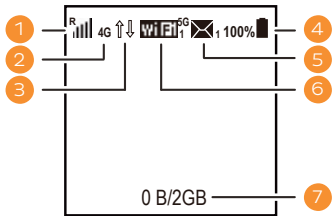

No.	Item
1	<b>Signal strength</b> <ul style="list-style-type: none"><li>▬ ▬ ▬ ▬ ▬ : Signal strength from weak to strong.</li><li>• R: Data roaming (Not supported by iiNet Group)</li></ul>
2	<b>Network type</b> <ul style="list-style-type: none"><li>• 2G/3G/4G: Connected to a 2G/3G/4G mobile network.</li></ul>
3	<b>Network connection status</b> <ul style="list-style-type: none"><li>• Displays when internet connection is set up.</li></ul>
4	<b>Battery</b>

5	<p><b>SMS (not supported)</b> Displays when internet connection is set up.</p>
6	<p><b>Wi-Fi</b></p> <ul style="list-style-type: none"> <li>• Wi-Fi turned on (5G indicates 5GHz network).</li> <li>• Number of connected Wi-Fi devices.</li> </ul>
7	<p><b>Data statistics</b></p> <ul style="list-style-type: none"> <li>• Data usage information.</li> </ul>

**Note:**

Data usage information provided is a rough guide and not a precise measurement. For detailed usage information, please log in to the customer portal on our website, or call us using the contact information on the back of this guide.

## Getting Started

### Inserting the SIM Card

**Note:**

Only a micro size SIM card is compatible with the MobiiHotspot 4G. DO NOT attempt to use a Nano SIM or microSD card in the SIM slot of this device.

Insert the SIM card according to the diagram on the next page.

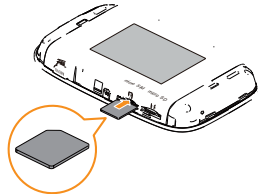
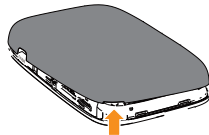
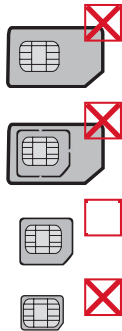

### Inserting the SIM card:

1. Use the notch on top right of the MobiiHotspot 4G to remove the back cover.
2. Carefully check for the micro SIM label above the SIM slot.
3. Insert the micro SIM so the gold shiny part faces the same way as the display screen on the front of the device.

## Inserting the microSD Card

The microSD card is an optional accessory that may be purchased separately. You can insert it according to the diagram below.

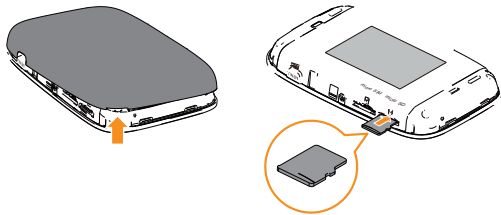

## Removing the SIM or microSD card:

- Remove the back panel of the MobiiHotspot.
- Gently press the card in with your fingertip, then release.
- The card will pop out enough to be removed.
- Do not remove any card while the MobiiHotspot 4G is in use. This may corrupt the data stored on the device, affecting the way the MobiiHotspot 4G operates.



## Wi-Fi SSID and Password

When you connect a device connects to the Wi-Fi for the first time, you'll need the Wi-Fi password. The name (SSID) of the MobiiHotspot 4G's default Wi-Fi network and its password are found on the sticker underneath the back cover.

When the device is turned on, you can also press the power button to view the Wi-Fi SSID and password on the display screen.

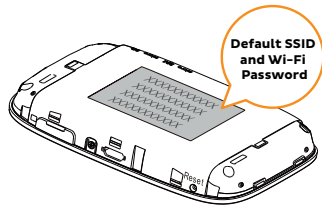



## Example: Wi-Fi Connection to Computer

1. Click the Wi-Fi or Network in the bottom right corner (Windows) or top right corner (Mac OSX) of your desktop screen.
2. Select the MobiiHotspot 4G's SSID from the list of Wi-Fi networks and click Connect/Join.
3. Enter the Wi-Fi password when prompted. See page 16 to learn where to find the default SSID and password.
4. Your device should remember the SSID and password from now on. For further instructions specific to your device, please contact the manufacturer.

### **Note:**

To use Wi-Fi, your computer must have a wireless network adapter. If the computer shows that Wi-Fi networks are available, the wireless network adapter is correctly installed.

## Example: Wi-Fi Connection to Android devices

1. Select Settings > Wi-Fi.
2. Your device will automatically detect the networks in range and display them in a list.
3. Select your Wi-Fi network name (SSID) from the list of available networks.
4. If necessary, enter a password and tap 'Connect'. (Networks requiring a password appear with a lock icon.)

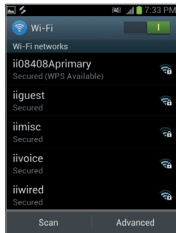

### Note:

Some Wi-Fi devices such as PS3, PS Vita and NDSi can also access the Internet via the MobiiHotspot 4G. To learn how, consult the user manuals of the devices you want to connect.



## Logging In to the Web Management Page

1. Make sure your computer or device is connected to the MobiiHotspot 4G. If you don't have a Wi-Fi connection, you can use the USB cable supplied.
2. Open a web browser and enter **http://192.168.1.1** in the address bar. Press **Enter** or **Go**.
3. Enter the user name and password required log in to the web management page.

### Default login information:

The default username is **admin**.

The default password is **admin**.

## Charging the Battery

There are two easy ways to charge your MobiiHotspot 4G.

**1. Plug the USB cable into the supplied charger and plug into an electrical outlet.**

**Note:**

Use of an incompatible charger or one from an unknown manufacturer may cause the MobiiHotspot 4G to become faulty, or could even cause a fire. It will also void all warranties, whether expressed or implied, on the product.

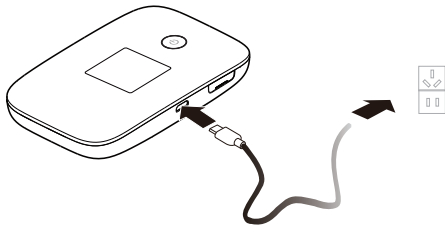

## 2. Charge the device through a computer connection

Use the USB cable provided to connect the MobiiHotspot 4G to a desktop computer or laptop that is turned on.

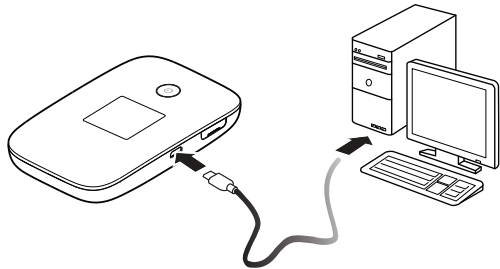





## Just one more thing

If your MobiiHotspot 4G is used in an environment with poor ventilation, it may overheat with extended use. If this happens, it will switch itself off and disconnect from the network automatically. Clever, isn't it?

If this happens, move your device to a well ventilated location and restart.

If you run into any trouble, try the following:

- See help on the web management page.
- Restart the MobiiHotspot 4G.
- Restore the factory defaults.
- Contact our Support Team using the information on the back cover.

## Hints and Tips for daily use

### Battery Saving Mode

If the MobiiHotspot 4G has been inactive for some time, it will enter standby mode and the display screen will turn off. Pressing any button will exit standby mode.

When the MobiiHotspot is running on battery power, you can choose to enable or disable the MobiiHotspot's automatic Wi-Fi function through the Web Management Page. If this function is enabled and if no Wi-Fi devices access the Wi-Fi for a period of time, the Wi-Fi will turn off.

You can press any button to turn the Wi-Fi on again.

**All Done.**

## Warranty

### 1 How to claim under the warranty and your rights

- 1.1 In order to claim under the warranty, you should contact us to advise that you wish to claim under the warranty and answer any questions we have. We will assess whether you are eligible to claim under the warranty and determine, at our option and in accordance with any specific terms that apply to the relevant equipment, whether to repair or replace your equipment, or provide a credit.

#### **iiNet:**

- Phone: 13 22 58
- Email: support@iinet.net.au

#### **Westnet:**

- Phone: 1300 786 068
- Email: support@westnet.com.au

#### **Internode:**

- Phone: 1300 788 233
- Email: support@internode.com.au

#### **TransACT:**

- Phone: 13 30 61
- Email: support@transact.com.au

#### **Adam Internet:**

- Phone: 1300 002 326
- Email: support@adam.com.au

- 1.2 If we determine that your equipment needs to be returned, you will be sent replacement equipment and a return freight bag in which to return the faulty equipment.
- 1.3 If the faulty equipment is not returned to us, with all cables, accessories and components, within 21 days of you receiving the replacement equipment and return freight bag, you will be charged the full price for the purchase of the equipment that we sent to you, plus any shipping costs relating to the prepaid satchel that was sent to you. You will also still be charged for the original equipment and if the original equipment has already been paid for, you will not be entitled to a refund.

- 1.4 The warranty does not apply to faults caused by any of the following (Non Covered Events):
- a) any equipment not supplied by us;
  - b) any interference with or modification to the equipment or a failure to use it in accordance with instructions; or
  - c) damage caused by you or someone who has used the equipment (for example misuse or exposure to liquid or excessive heat); or
  - d) an external event (for example a fire or flood).
- 1.5 If on inspection of the returned equipment we determine that the fault was caused by a Non Covered Event, you will be charged for the original equipment (or if the original equipment has already been paid for, you

will not be entitled to a refund) and the replacement equipment, unless:

- a) you have not used the replacement equipment;
- b) and you return it to us in its unopened packaging,

in which case, you will not be charged for the replacement equipment.

- 1.6 The repair or replacement of equipment may result in loss of data (such as loss of telephone numbers stored on your handset).
- 1.7 Goods presented for repair may be replaced by refurbished goods of the same type rather than being repaired. Refurbished parts may be used to repair the goods. If your equipment is replaced with refurbished

equipment, the warranty applies in relation to that refurbished equipment from the remainder of the original Warranty Period or thirty days, whichever is longer.

- 1.8 The benefits given to you by this warranty are in addition to other rights and remedies you may have at law.
- 1.9 Our goods come with guarantees that cannot be excluded under the Australian Consumer Law. You are entitled to a replacement or refund for a major failure and compensation for any other reasonably foreseeable loss or damage. You are also entitled to have the goods repaired or replaced if the goods fail to be of acceptable quality and the failure does not amount to a major failure.

1.10 This warranty is given by iiNet Limited (ACN 068 628 937) of 1/502 Hay Street, Subiaco, WA, 6008. You can contact us on **13 22 58** or via email to **support@iinet.net.au** if you have any questions regarding this warranty.

1.11 Latest Warranty Information: **<http://www.iinet.net.au/about/legal/pdf/general-equipment-warranty.pdf>**

## **2 Warranty Period**

**Purchase: 24 Months**

**Rental: For the lifetime of the Rental Contract**

2.1 You must notify us of the fault with your equipment within the applicable Warranty Period (beginning from the date you purchased the equipment)

2.2 We will repair, replace or provide credit for faulty equipment provided by us at no cost to you, if you notify us of the fault within the applicable Warranty Period.

2.3 However, we will charge you for the repair or replacement of faulty equipment, if the fault was caused by a Non Covered Event.

2.4 If we decide to repair the equipment, you must give us sufficient information to assess the fault, including allowing us to test your personal computer.

**iiNet Support**

13 22 58

support@iinet.net.au

**iiNet Business Support**

13 24 49

bizsupport@iinet.net.au

**Adam Internet**

1300 002 326

support@adam.com.au

**Westnet Support**

1300 786 068

support@westnet.com.au

**TransACT Support**

13 30 61

support@transact.com.au

**Internode Support**

13 66 33

support@internode.on.net